

000.620 PD - 007 - BILL OF MATERIALS 3 LITE

ITEM NO.	DESCRIPTION	QUANTITY	PART NO.	FAB DWG. NO	SOURCE
1	FXD PNL TOP RAIL	2	10001102	10001102-F-01	A
2	STILE	4	10001102	10001102-F-01	A
3	BOTTOM RAIL	2	10001102	10001102-F-02	A
4	INTERLOCK	1	10001117	10001117-F-04	A
5	SCREW COVER	1	10001118	10001111-F-01	A
6	GLAZING BEAD	8	10001111	10001111-F-01	A
7	STILE REINFORCEMENT - JAMB	2	10300150	10300150	PPPP
8	STILE REINFORCEMENT - INTERLOCK	2	10300151	10300151	PPPP
9	WEATHER STRIPPING - 270 x 250	AS RECD	W21255MW	STRAIGHT CUT	HHHH
10					
11	OPR PNL RAIL - TOP	1	10001102	10001102-F-01	A
12	STILE - INTERLOCK	1	10001102	10001102-F-03	A
13	STILE - LOCK	1	10001102	10001102-F-10	A
14	RAIL - BOTTOM	1	10001102	10001102-F-05	A
15	3 LITE ASTRAGAL	1	10001115	10001115-F-01	A
16	3 LITE KEEPER REINFORCEMENT	1	10001115	10001115-F-01	A
17	3 LITE KEEPER REINFORCEMENT COVER	1	10005870	STRAIGHT CUT	METALS DEPOT
18	INTERLOCK	1	10001117	STRAIGHT CUT	A
19	SCREW COVER	1	10001117	10001117-F-02	A
20	GLAZING BEAD	1	10001118	STRAIGHT CUT	A
21	STILE REINFORCEMENT - INTERLOCK	4	10001111	10001111-F-01	A
22	STILE REINFORCEMENT - LOCK	1	10300151	STRAIGHT CUT	PPPP
23	RAIL REINFORCEMENT - BOTTOM	1	10300150	10300150-F-01	PPPP
24	WEATHER STRIPPING - 270 x 250	1	10300152	10300152-F-01	PPPP
25			W21255MW		HHHH
26	MISC LOCK SET ASSEMBLY - 2817 LOCK W/ TRIMPLATE	1	DECU-XXXX		F
27	HANDLE SET ASSEMBLY	1	DECU-XXX1		F
28	HANDLE SET - INTERIOR SWITCH		DECU-XXX2		
29	HANDLE SET - INTERIOR SWITCH / KEY		DECU-XXX3		
30	HANDLE SET - BLANK		1988PRS168REVSS		F
31	ROLLER ASSEMBLY - PRECISION 1.98" WHEEL	2	D90964MMWC 0.810		HHHH
32	DRAFT PLUG - .810 DIA	2	9946		D
33	3/8" HOLE PLUG	2	DECU-2808-84		F
34	KEEPER - 2778 KEEPER - STAINLESS STEEL	1	011H055-D		MMMM
35	IMPACT BRACKET	2			
36	1" INSULATED GLASS - NOTE	3			
37	SETTING BLOCS (REFER TO 3 SURFACE DRAWINGS)	AS RECD			
38	GLAZING COMPOUND	AS RECD			
39					
40	SCREWS LOCK SET	2	#10 x 1.25" PPH - 410SS		
41	ROLLER ASSEMBLY	4	#8 x 3/4" PPH - 410SS		
42	REINFORCEMENT TO PANEL	AS RECD	#8 x 1" PPH - 410SS		
43	INTERLOCK	AS RECD	#8 x 5/8" PPH - 410SS		
44	KEEPER	4	#8 x 2" PPH - 410SS		
45	3 LITE KEEPER REINFORCEMENT	3	#8 x 1.25" PPH - 410SS		
46	IMPACT BRACKET	6	#9 x 2.5" PPH - PAINTED		
47					

ELEMENT MATERIALS TECHNOLOGY
 1924 Premier Row
 Orlando, FL 32809

ESP NO. ESP1091608-0
 Date Verified: 4/2/12

NOTE LAMINATED GLASS UTILIZES .090" SOLUTIA PVB

REV	DATE	DESCRIPTION	BY

CONFIDENTIAL
 UNPUBLISHED WORK © 2010
 DECEUNINCK NORTH AMERICA

MONROE, OH
 NAME: 000.620 PD - 007
 DWN BY: JGM
 CHKD BY: JGM
 DWG NO: 000620PD-007

THIS DOCUMENT CONTAINS PROPRIETARY AND CONFIDENTIAL INFORMATION. DO NOT COPY OR DISCLOSE THIS INFORMATION WITHOUT THE EXPRESS WRITTEN CONSENT OF DECEUNINCK NORTH AMERICA. DECEUNINCK NORTH AMERICA RESERVES THE RIGHT TO CHANGE THIS DRAWING AND ANY ASSOCIATED DOCUMENTS.

P-1e

623.000 PD - 004 - BILL OF MATERIALS 3 & 4 LITE

ITEM NO.	DESCRIPTION	QUANTITY	PART NO.	FAB DWG. NO	SOURCE
1	HEAD	1			
2	JAMB	2	10001100	10001100-F-01	A
3	EXTERIOR FRAME COVER	2	10001100	10001100-F-05	A
4	INTERIOR FRAME COVER	2	10001104	10001104-F-01	A
5	SILL	4	10001104	STRAIGHT CUT	A
6	SILL THRESHOLD	1	10001101	10001101-F-01	A
7	SILL RISER	1	10300171	10300171-F-01	PPPP
8	WEATHER-STRIPPING - .270 x .250	2	10001105	10001105-F-01	A
9			W21255MW		HHHH
10	MISC				
11	ROLLER TRACK CAP	6	10300148	10300148-F-01	PPPP
12	L - BRACKET	1	1A16719	STRAIGHT CUT	N
13	SILL FRAME GASKET	4	011H027		LLLL
14	FRAME REINFORCEMENT	2	G-A302-Z1-G600		CC
15	KEEPER	4	10300149		PPPP
16	2778 KEEPER - YZD MILD STEEL	1		STRAIGHT CUT	F
17	2778 KEEPER - STAINLESS STEEL		DECU-2808-00		DDDD
18	T - BRACKET		DECU-2808-84		MMMM
19	SCREEN KEEPER	1 OR 2	10300213		
20	BUMPER STOP	1	011H040		
21		2 OR 4	2152.525		
22	SCREWS				
23	SNUBBER	36	#8 x 1.25" PFH - 410SS		
24	L - BRACKET - SASH	8	#8 x 1" PFH - 410SS		
25	L - BRACKET - HEAD	8	#8 x 0.75" PFH - 410SS		
26	L - BRACKET - HEAD	8	#8 x 2.5" PFH - 410SS		
27	SILL RISER	4	#8 x 2.5" PFH - 410SS		
28	FRAME ASSEMBLY	4	#8 x 1.25" PFH - 410SS		
29	SCREEN KEEPER	12	#8 x 2.5" PPH - 410SS		
30	T - BRACKET	2	#6 x .375" PPH		
31		8 OR 16	#8 x 2.5" PFH - 410SS		

ELEMENT MATERIALS TECHNOLOGY
 1924 Premier Row
 Orlando, FL 32809

ESP NO. ES1009160A6
 Date Verified: 4/24/12
 Verified By: [Signature]

REV	DATE	DESCRIPTION	BY

CONFIDENTIAL
 UNPUBLISHED WORK © 2010
 DECEUNINCK NORTH AMERICA

NAME: MONROE, OH DWN BY: JGM CHKD BY: JGM DWG NO: 623000PD-004	COPYRIGHT 2010 623.000 PD - 004
---	------------------------------------

THIS DOCUMENT CONTAINS PROPRIETARY AND CONFIDENTIAL INFORMATION. DO NOT COPY OR DISCLOSE THIS INFORMATION WITHOUT THE EXPRESS WRITTEN CONSENT OF DECEUNINCK NORTH AMERICA. DECEUNINCK NORTH AMERICA RESERVES THE RIGHT TO CHANGE THIS DRAWING AND ANY ASSOCIATED DOCUMENTS.

ELEMENT MATERIALS TECHNOLOGY

CAD DRAWINGS, CHANGES, SOLIDS, ETC.
INCORPORATED BY THE DESIGN CENTER.

1924 Premier Row
Orlando, FL 32809

REV	DESCRIPTION	DATE	APPROVED

ESP NO. ESP009160P-6
 Date Verified: 4/26/12
 Verified By: mm

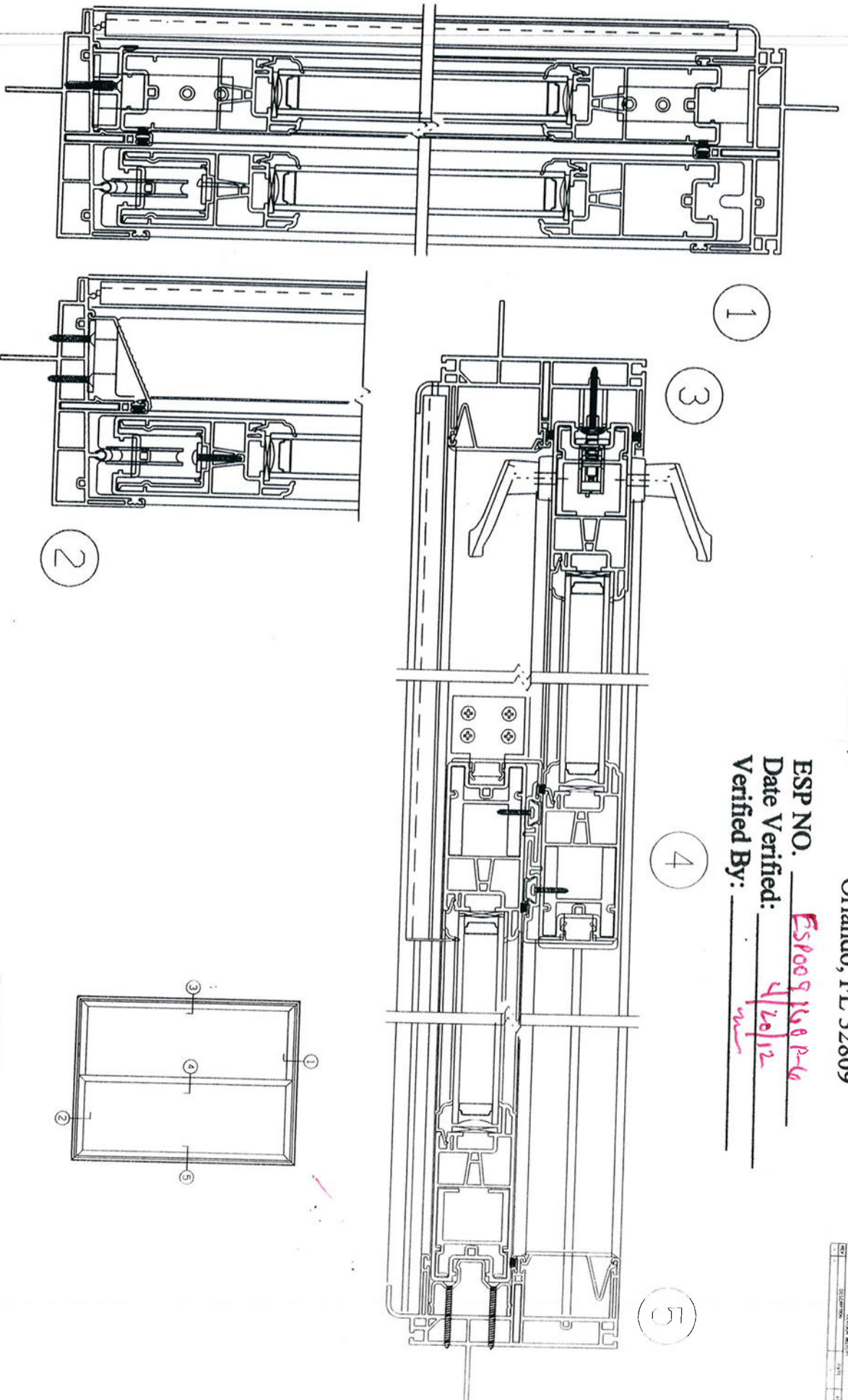

CONFIDENTIAL

DATE: 08/08/08
 DRAWN BY: [Redacted]
 CHECKED BY: [Redacted]
 APPROVED BY: [Redacted]

PROJECT: 1924 Premier Row
 DRAWING NO: 5231620 PD - 003

REVISIONS:

NO.	DESCRIPTION	DATE	BY

document

CAD DRAWINGS, QUOTES SHALL BE
INCORPORATED BY THE DESIGN ACTIVITY.

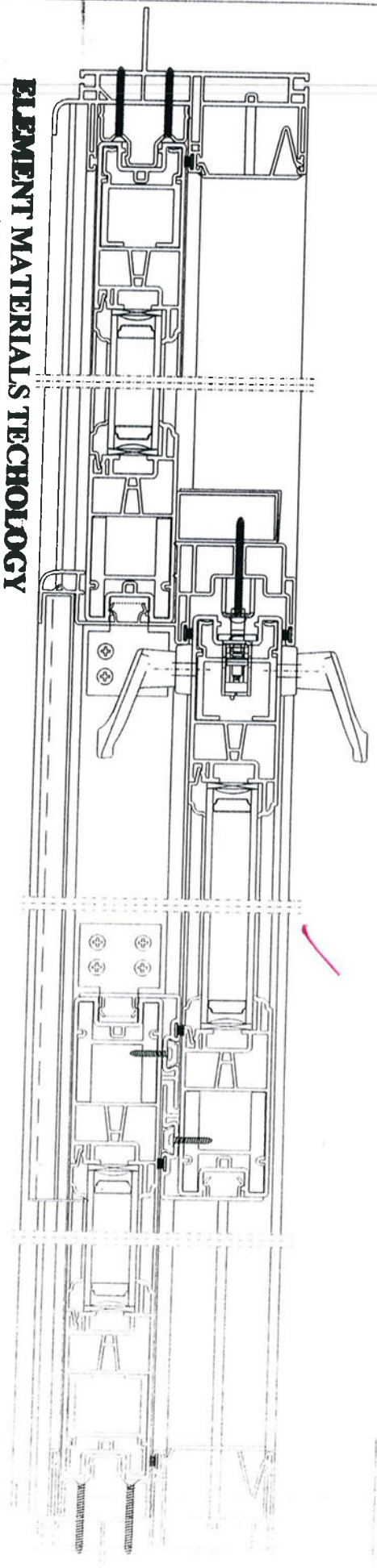

ELEMENT MATERIALS TECHNOLOGY

1924 Premier Row
Orlando, FL 32809

ESP NO. ESP009160P-6

Date Verified: 4/20/12

Verified By: _____

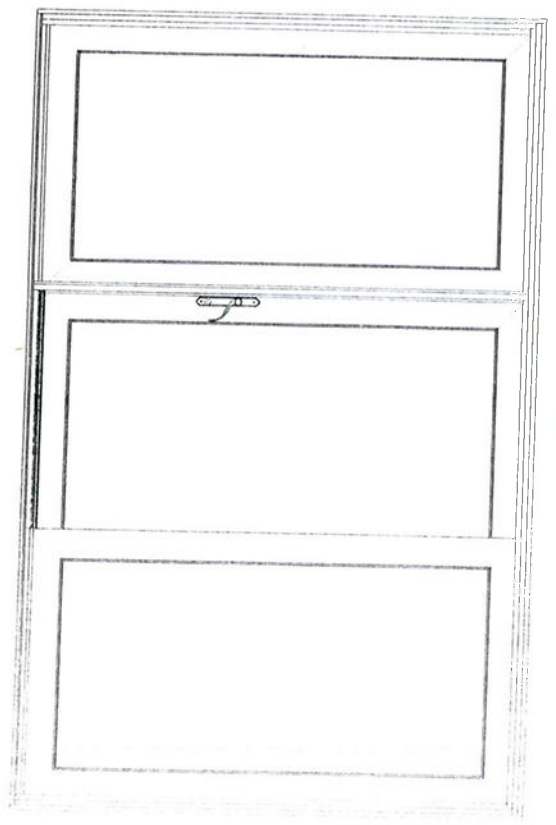
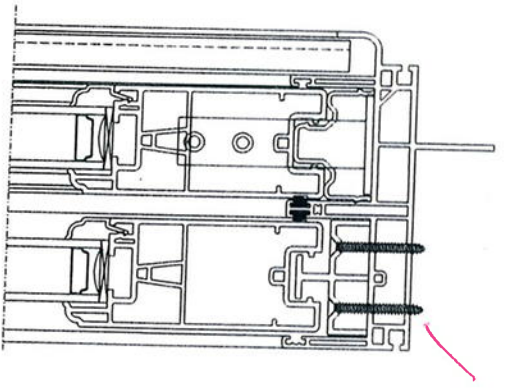

CONFIDENTIAL

UNPUBLISHED WORK © 2010
 DEPENDENCE NORTH AMERICA
 14000 W. BAYVIEW BLVD., SUITE 100
 MIAMI, FL 33187
 TEL: 305.444.1100
 FAX: 305.444.1101
 WWW.DENPENDENCE.COM

DATE: 4/20/12
 BY: [Signature]
 CHECKED BY: [Signature]
 APPROVED BY: [Signature]

PROJECT: 1924 PREMIER ROW
 DRAWING NO: ESP009160P-6
 SHEET NO: 01

NOTES:
1. REFER TO DRAWING ESP009160P-01 FOR VERTICAL CROSS SECTION ONLY.

CAD MAINTAINED. CHANGES SHALL BE INCORPORATED BY THE DESIGN ACTIVITY.

ELEMENT MATERIALS TECHNOLOGY
 1924 Premier Row
 Orlando, FL 32809

ESEP NO. *ESP0051100P-16*
 Date Verified: *4/26/12*
 Verified By: *[Signature]*

WALL THICKNESS

.090 -	[White]
.060 -	[Hatched]
.050 -	[Black]
.040 -	[Dark Grey]

KEY PRODUCT CHARACTERISTICS

G	DIMENSION L282 - L322
J	DIMENSION .608 - .638
Q	DIMENSION L180 - L130
V	DIMENSION L885 - L905
Z	GAUGE DNA-28I
AH	DIMENSION J05 - .125
AN	DIMENSION J05 - .125

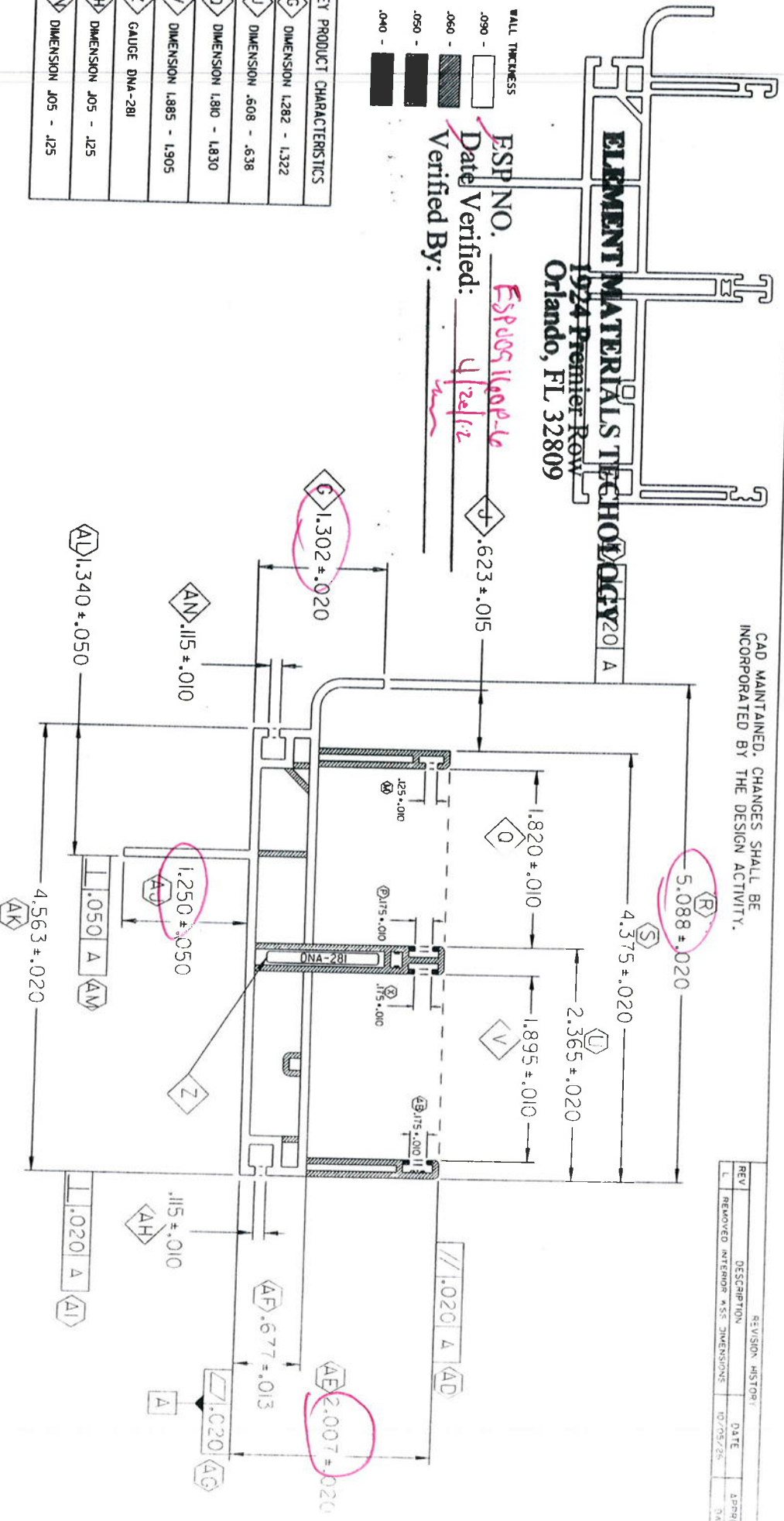

NOTES:

1. 'STDD0013' STRAIGHTNESS CLASS A AND LENGTH TOLERANCES APPLY(A)
2. INTERPRET ALL TOLERANCE APPLICATIONS PER STDD0013(B)
3. UNSPECIFIED EXTERNAL RADII = .XXX +.010 / -.005(C)
4. UNSPECIFIED INTERNAL RADII = .XXX +.020 / -.005(D)
5. UNSPECIFIED EXTERNAL WALL THICKNESS = .XXX +/- .10%(E)
6. UNSPECIFIED INTERNAL WALL THICKNESS = .XXX +/- .20%(E)

CONFIDENTIAL
 UNPUBLISHED WORK © 2010
 DECEUNINCK NORTH AMERICA
 THIS DOCUMENT CONTAINS PROPRIETARY AND CONFIDENTIAL INFORMATION. DO NOT COPY OR DISCLOSE THE INFORMATION WITHOUT THE EXPRESS WRITTEN CONSENT OF DECEUNINCK NORTH AMERICA. DECEUNINCK NORTH AMERICA RESERVES THE RIGHT TO CHANGE THIS DRAWING AND ANY ASSOCIATED DOCUMENTS.

UNLESS OTHERWISE SPECIFIED DIM ARE IN INCHES

2 PL: ±0.010°	3 PL: ±0.005°
INTERPRET DIM AND TOL PER ASME Y14.5M - 1994	
THIRD ANGLE PROJECTION	

DESIGN BY: CTC	
DATE: 05/03/10	DRAWN BY: CTC
DATE: 05/03/10	DATE: 05/03/10
DATE: [Blank]	DATE: [Blank]
DATE: [Blank]	DATE: [Blank]
DATE: [Blank]	DATE: [Blank]
DATE: [Blank]	DATE: [Blank]
DATE: [Blank]	DATE: [Blank]

NAME: MAIN FRAME - PD
 SCALE: 1:1
 SHEETS: 1 OF 1

REV	DESCRIPTION	DATE	APPROVED
L	REMOVED EXTERIOR ASS. DIMENSIONS	10/05/26	QAD

CAD MAINTAINED. CHANGES SHALL BE INCORPORATED BY THE DESIGN ACTIVITY.

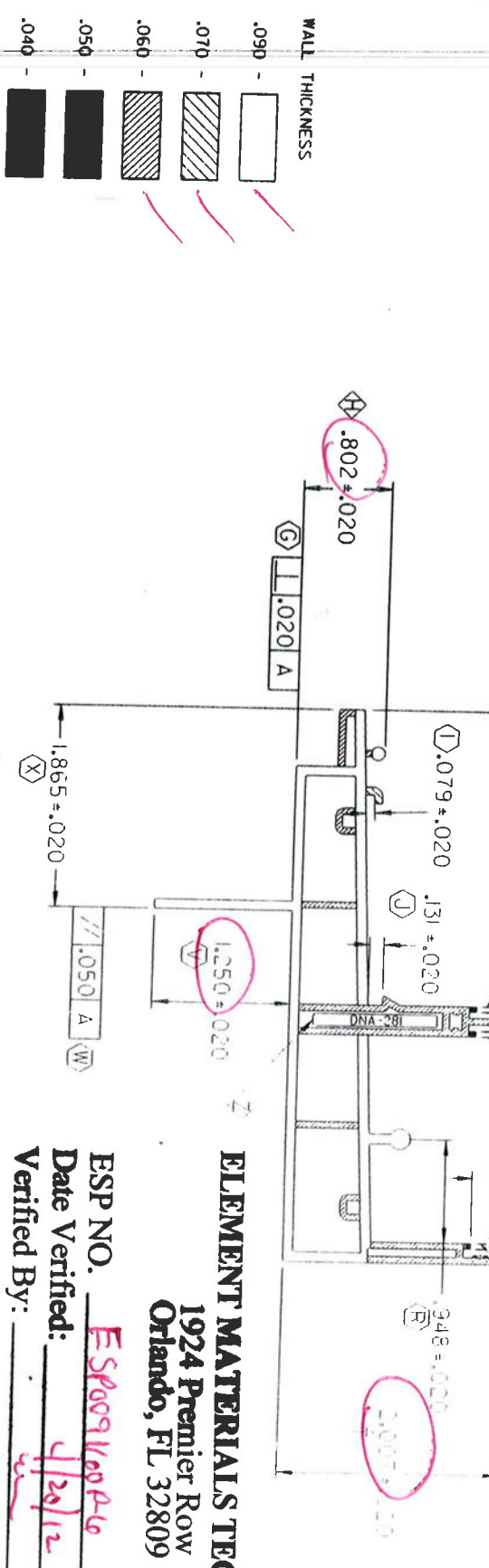
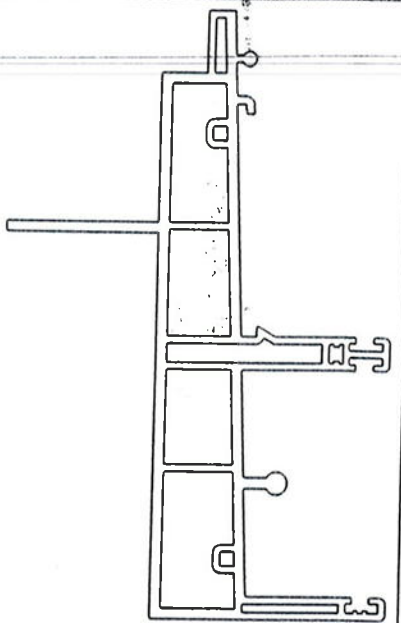

ELEMENT MATERIALS TECHNOLOGY
1924 Premier Row
Orlando, FL 32809
ESP NO. E5800910026
Date Verified: 1/20/12
Verified By: [Signature]

- NOTES:
1. STIDD00013' STRAIGHTNESS CLASS A AND LENGTH TOLERANCES APPLY **(A)**
 2. INTERPRET ALL TOLERANCE APPLICATIONS PER STIDD00013 **(B)**
 3. UNSPECIFIED EXTERNAL RADI = .XXX +.010 / -.005 **(C)**
 4. UNSPECIFIED INTERNAL RADI = .XXX +.020 / -.005 **(D)**
 5. UNSPECIFIED EXTERNAL WALL THICKNESS = .XXX +/- .10% **(E)**
 6. UNSPECIFIED INTERNAL WALL THICKNESS = .XXX +/- .20% **(E)**

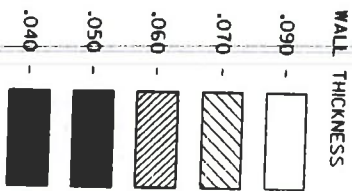

CONFIDENTIAL
 UNPUBLISHED WORK © 2011
 DECEUNINCK NORTH AMERICA
 THIS DOCUMENT CONTAINS PROPRIETARY AND CONFIDENTIAL INFORMATION. DO NOT COPY, REPRODUCE, DISSEMINATE, OR TRANSMIT THIS INFORMATION WITHOUT THE EXPRESS WRITTEN CONSENT OF DECEUNINCK NORTH AMERICA. ANY CHANGE TO THIS DRAWING AND ANY ASSOCIATED DOCUMENTS.

UNLESS OTHERWISE SPECIFIED DIM ARE IN INCHES
 2 PL: 0.0005
 INTERPRET DIM AND TOL PER ASME Y14.5M - 1994

DESIGN BY:	RJC
DATE:	00/10/20
DRAWN BY:	RLC
DATE:	00/10/20
AUTH:	DATE:
AUTH:	DATE:
FILENAME:	

SCALE: **B**

DATE: 00/10/20

SCALE: 1:1

deceuninck
 NORTH AMERICA

311 North Main Street
 Orange Park, FL 32067

REV	DESCRIPTION	DATE	BY
1	CHANGED DATA	00/10/20	RJC
2			
3			
4			
5			
6			
7			
8			
9			
10			

CAD MAINTAINED. CHANGES SHALL BE INCORPORATED BY THE DESIGN ACTIVITY.

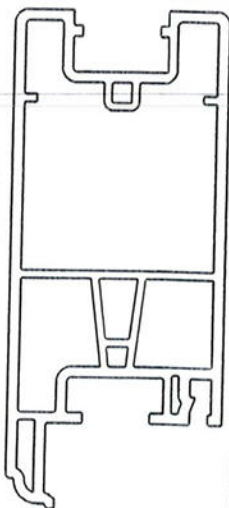

ELEMENT MATERIALS TECHNOLOGY
 1924 Premier Row
 Orlando, FL 32809

ESP NO. ESP00910086
 Date Verified: 4/26/12
 Verified By: [Signature]

KEY PRODUCT CHARACTERISTICS	
G	DIMENSION .790 - .810
H	DIMENSION 1.745 - 1.775
I	DIMENSION 3.292 - 3.332
J	DIMENSION .130 - .150
L	DIMENSION .790 - .810

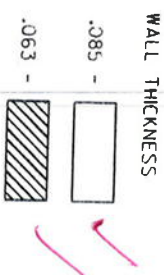
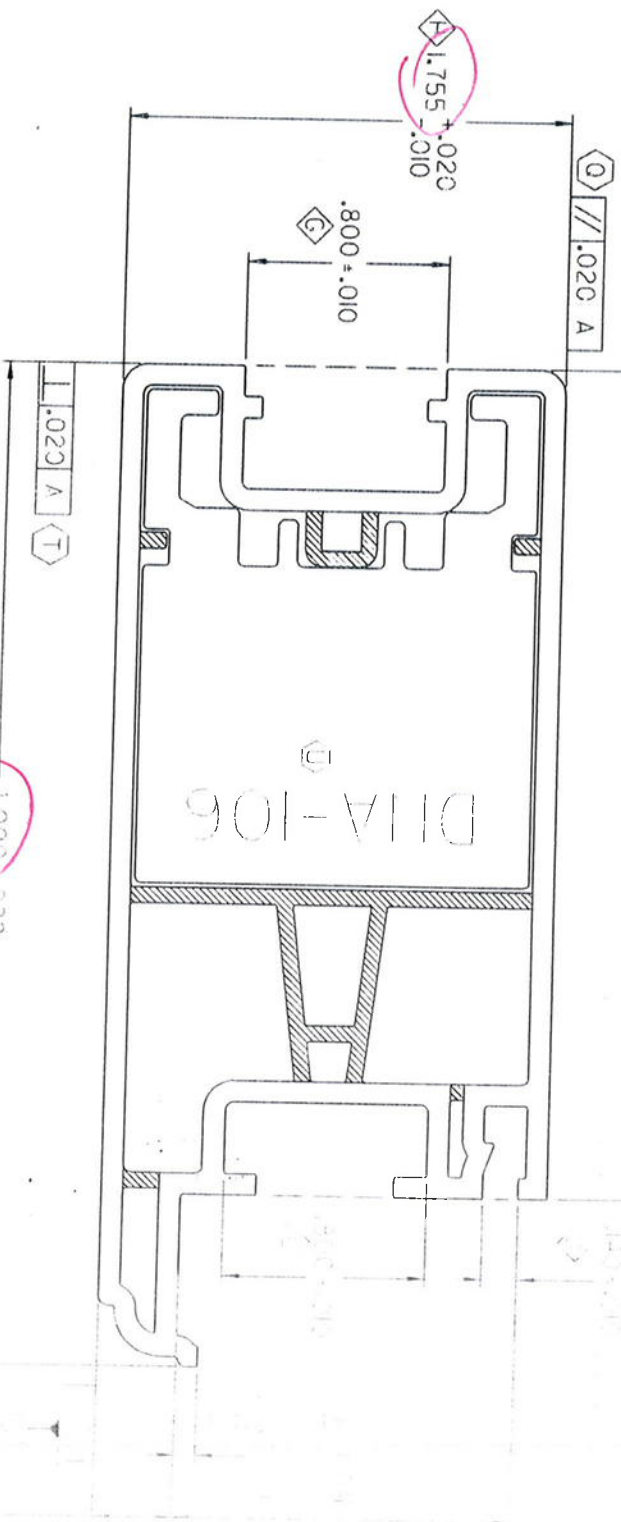

NOTES:

1. 'STD0003' STRAIGHTNESS CLASS B AND LENGTH TOLERANCES APPLY (A)
2. INTERPRET ALL TOLERANCE APPLICATIONS PER STD0003 (B)
3. UNSPECIFIED EXTERNAL RADII = .XXX +.010 / -.005 (C)
4. UNSPECIFIED INTERNAL RADII = .XXX +.020 / -.005 (D)
5. UNSPECIFIED EXTERNAL WALL THICKNESS = .XXX +/- 10% (E)
6. UNSPECIFIED INTERNAL WALL THICKNESS = .XXX +/- 20% (F)

CONFIDENTIAL
 UNPUBLISHED WORK © 2008
 DECEUNINCK NORTH AMERICA

THIS DOCUMENT CONTAINS PROPRIETARY AND CONFIDENTIAL INFORMATION. DO NOT DISCLOSE OR DISCLOSE THIS INFORMATION OF DECEUNINCK NORTH AMERICA. DECEUNINCK NORTH AMERICA RESERVES THE RIGHT TO CHANGE THIS DRAWING AND ANY ASSOCIATED DOCUMENTS.

DATE	BY	DESCRIPTION
01/06/11	SJO	DESIGN B11
01/05/11	SJO	DESIGN B11
01/05/11	SJO	DESIGN B11

deceuninck
 NORTH AMERICA

Member of the
 Axalta Group



SCALE 1:1

CAD MAINTAINED. CHANGES SHALL BE INCORPORATED BY THE DESIGN ACTIVITY.
ELEMENT MATERIALS TECHNOLOGY
 1924 Premier Row
 Orlando, FL 32809

ESP NO. ESP009160P-6
 Date Verified: 4/26/12
 Verified By: [Signature]

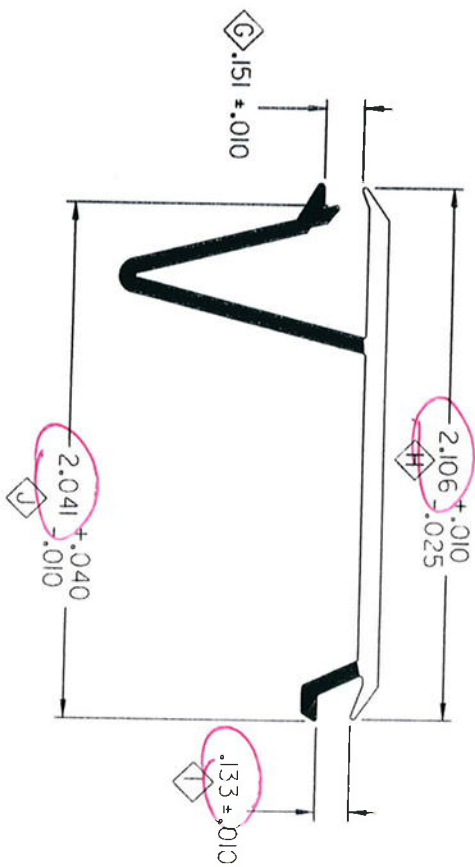

- NOTES:
1. 'STIDD0003' STRAIGHTNESS CLASS E AND LENGTH TOLERANCES APPLY. (A)
 2. INTERPRET ALL TOLERANCE APPLICATIONS PER STIDD0003 (B)
 3. UNSPECIFIED EXTERNAL RADIUS = .XXX +.000 / -.005 (C)
 4. UNSPECIFIED EXTERNAL WALL THICKNESS = .XXX +/- .020 (D)
 5. UNSPECIFIED INTERNAL RADIUS = .XXX +.020 / -.005 (E)
 6. UNSPECIFIED INTERNAL WALL THICKNESS = .XXX +/- .020 (F)

CONFIDENTIAL

UNPUBLISHED WORK © 2010
 DECEUNINCK NORTH AMERICA

THIS DOCUMENT CONTAINS PROPRIETARY AND CONFIDENTIAL INFORMATION. DO NOT COPY OR DISCLOSE THIS INFORMATION WITHOUT THE EXPRESS WRITTEN CONSENT OF DECEUNINCK NORTH AMERICA. DECEUNINCK NORTH AMERICA RESERVES THE RIGHT TO CHANGE THIS DRAWING AND ANY ASSOCIATED DOCUMENTS.

UNLESS OTHERWISE SPECIFIED
 DIM ARE IN INCHES
 2 PL.: ± .010° 3 PL.: ± .005°
 INTERPRET DIM AND TOL. PER
 ASME Y14.5M - 1994

THIRD ANGLE PROJECTION

DESIGN BY: CTC
 DATE: 05/11/14

DRAWN BY: CTC
 DATE: 05/11/14

DATE: DATE:
 DATE: DATE:

FLERNAME: 102726

NAME: **deceuninck** NORTH AMERICA

FRAME ADAPTOR

SIZE/DWG. NO: 1000104.SH

SCALE: 2:1 TBS/PT: .087 SHEET: 10-1

REV	DESCRIPTION	DATE	APPROVED
0	KAC	10/18/25	PKG

KEY PRODUCT CHARACTERISTICS
C DIMENSION: .141 - .161
H DIMENSION: 2.091 - 2.116
I DIMENSION: .123 - .143
J DIMENSION: 2.031 - 2.051

1 WALL THICKNESS
0.100
0.080

3 0.656
0.656

6 CHECK SNAP IN PART 1101

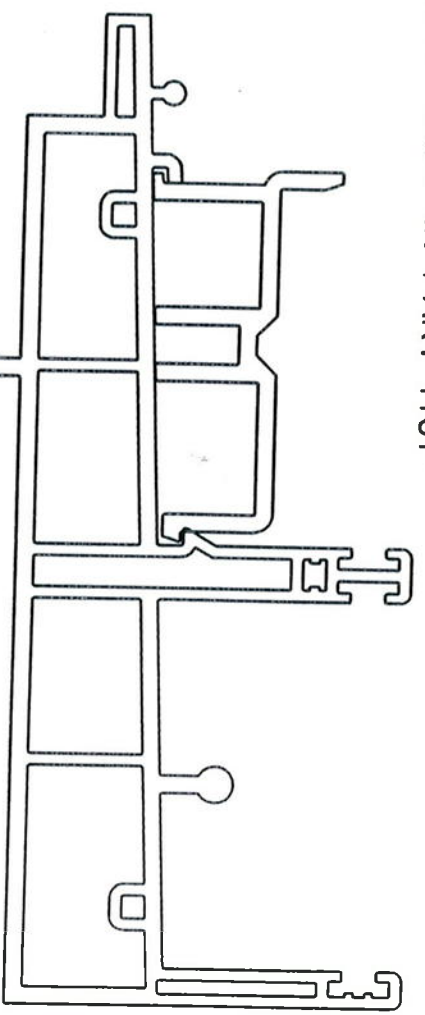
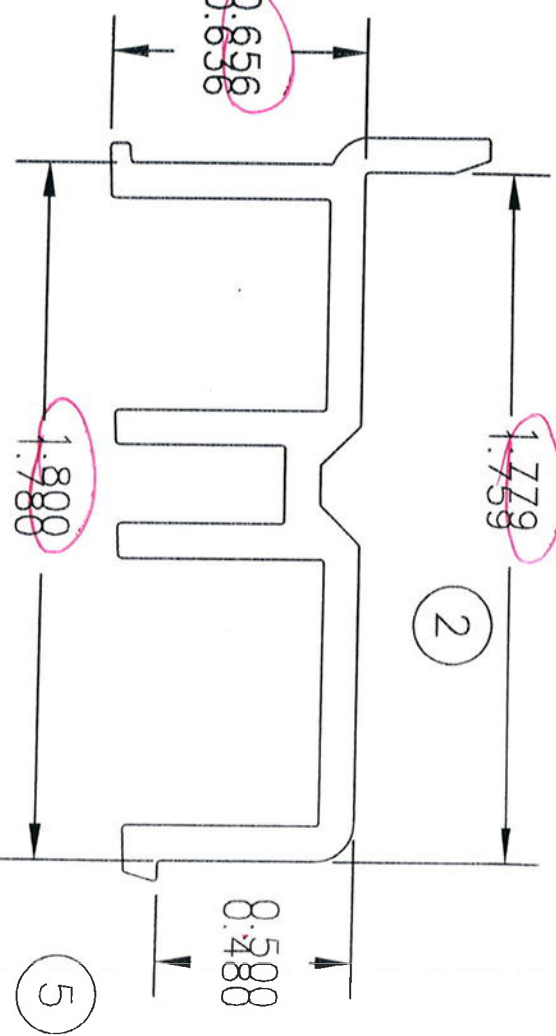

ELEMENT MATERIALS TECHNOLOGY
1924 Premier Row
Orlando, FL 32809

ESP NO. ESP009160P-C
Date Verified: 4/2/12
Verified By: [Signature]



Deceuninck® NORTH AMERICA/Oakland NJ
AREA=
TOTAL WEIGHT=
TOL: ±0.010
FILENAME:
path
BY DATE DATE MATL SCALE
CTC 11/14/05 PVC 2:1

SILL INSERT

10001105_SH

REV	BY	APP'VD	DATE	CHANGE



SCALE 1:1

ELEMENT MATERIALS TECHNOLOGY
 CAD MAINTAINED. CHANGES SHALL BE
 APPROVED BY THE DESIGN ACTIVITY.
 1924 Premier Row
 Orlando, FL 32809

ESP NO. ESP009160P-10
 Date Verified: 4/22/12
 Verified By: _____

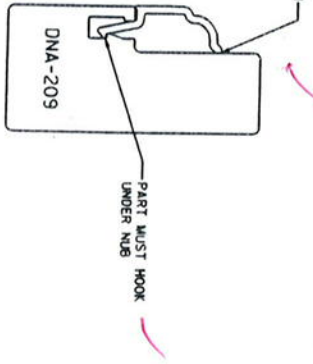

SLIDE PART INTO GAUGE FROM THE END. PART WILL NOT SNAP INTO GAUGE

WALL THICKNESS
 .060 -

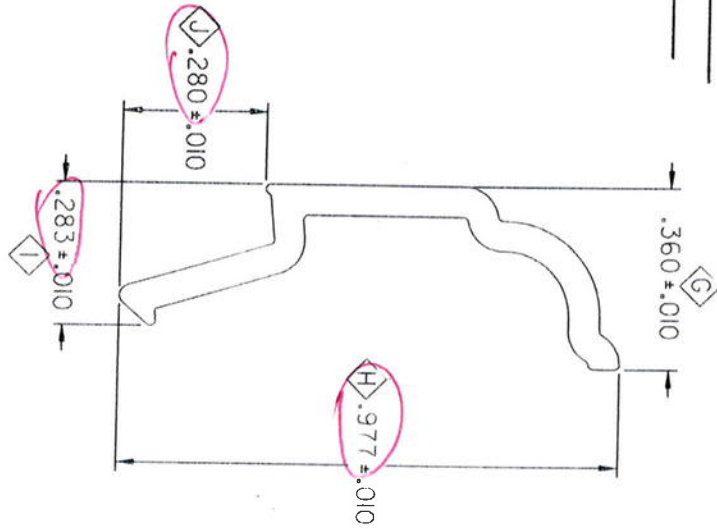

USE MYLAR 1000III111OP REV D

- NOTES:
- STANDARD STRAIGHTNESS CLASS A AND LENGTH TOLERANCES APPLY (A)
 - INTERPRET ALL TOLERANCE APPLICATIONS PER STANDARD (B)
 - UNSPECIFIED EXTERNAL RADIUS = .XXX ± .010 / -.005 (C)
 - UNSPECIFIED INTERNAL RADIUS = .XXX ± .020 / -.005 (D)
 - UNSPECIFIED EXTERNAL WALL THICKNESS = .XXX ± .007 (E)
 - UNSPECIFIED INTERNAL WALL THICKNESS = .XXX ± .020 (F)

CONFIDENTIAL
 UNPUBLISHED WORK © 2010
 DECEUNINCK NORTH AMERICA

THIS DOCUMENT CONTAINS PROPRIETARY AND CONFIDENTIAL INFORMATION. DO NOT COPY, OR DISCLOSE THIS INFORMATION WITHOUT THE EXPRESS WRITTEN CONSENT OF DECEUNINCK NORTH AMERICA. DECEUNINCK NORTH AMERICA RESERVES THE RIGHT TO CHANGE THIS DRAWING AND ANY ASSOCIATED DOCUMENTS.

UNLESS OTHERWISE SPECIFIED DIMENSIONS ARE IN INCHES
 TOL. ON ANGLES: .1°
 2 PL. ± 0.010° 3 PL. ± 0.005°
 INTERPRET DIM AND TOL. PER
 ASME Y14.5M - 1994

THIRD ANGLE PROJECTION

DESIGN BY:	MG
DATE:	00/12/20
DRAWN BY:	MG
DATE:	00/12/20
ADTH:	DATE:
ADTH:	DATE:
FILENAME:	105344

deceuninck & north america







GLAZING BEAD

STERLING, NJ 10021111 SH

SCALE: 4:1 (1/8"=1") .006 SHEETS

REV	DESCRIPTION	DATE	APPROVED
E	CHANGED MYLAR		

REVISION HISTORY			
REV	DESCRIPTION	DATE	APPROVED
G	GAUGE DNA-209		
H	GAUGE DNA-209		
I	GAUGE DNA-209		
J	GAUGE DNA-209		

- 1 WALL THICKNESS
-  0.080
 -  0.060
 -  0.060
 -  0.040
 -  0.050
 -  0.030

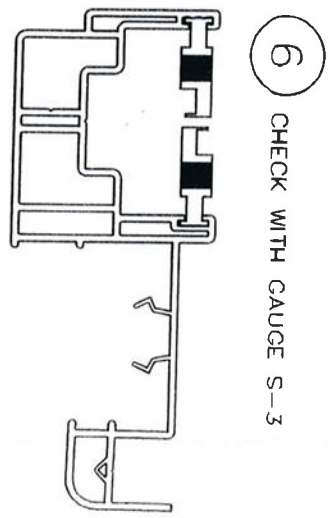
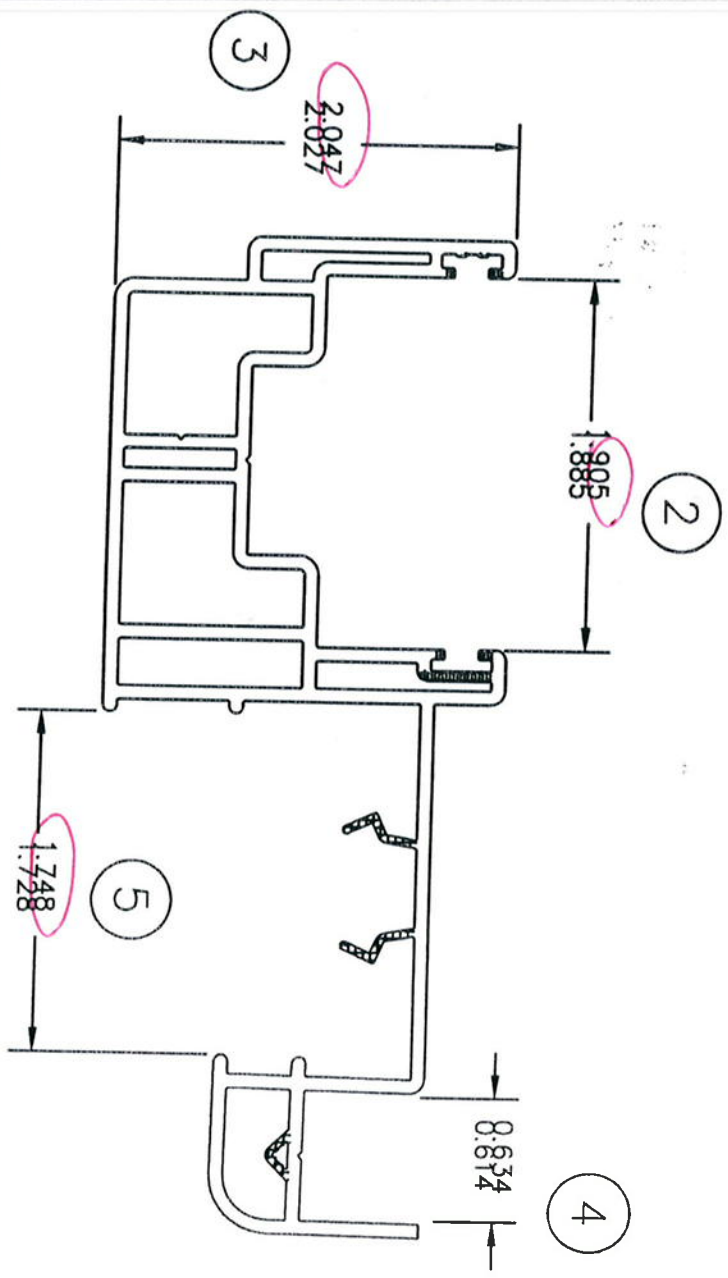

7 CHECK SNAP IN APPROVED PART 10001102.

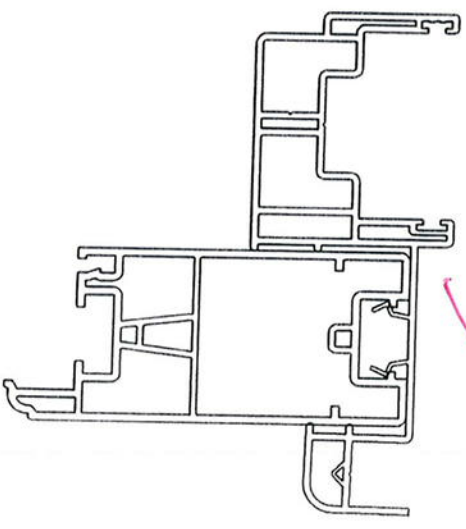

ELEMENT MATERIALS TECHNOLOGY
 1924 Premier Row
 Orlando, FL 32809

ESP NO. ESP0091100 P-10
 Date Verified: 5/4/12
 Verified By: [Signature]



Deceuninck® NORTH AMERICA/Oakland NJ

AREA= _____
 TOTAL WEIGHT= .874
 TOL: ±0.010

FILENAME: _____
 path _____

BY	DATE	MATL	SCALE
CTC	11/14/05	PVC	1:1

3-LITE JAMB

CHANGE

REV	BY	APPVD	DATE
-----	----	-------	------

10001115

ELEMENT MATERIALS TECHNOLOGY
 1924 Premier Row
 Orlando, FL 32809

CAD MAINTAINED CHANGES SHALL BE THE DESIGN ACTIVITY.

ESP NO. ESP009160P-6
 Date Verified: 4/20/12
 Verified By: [Signature]

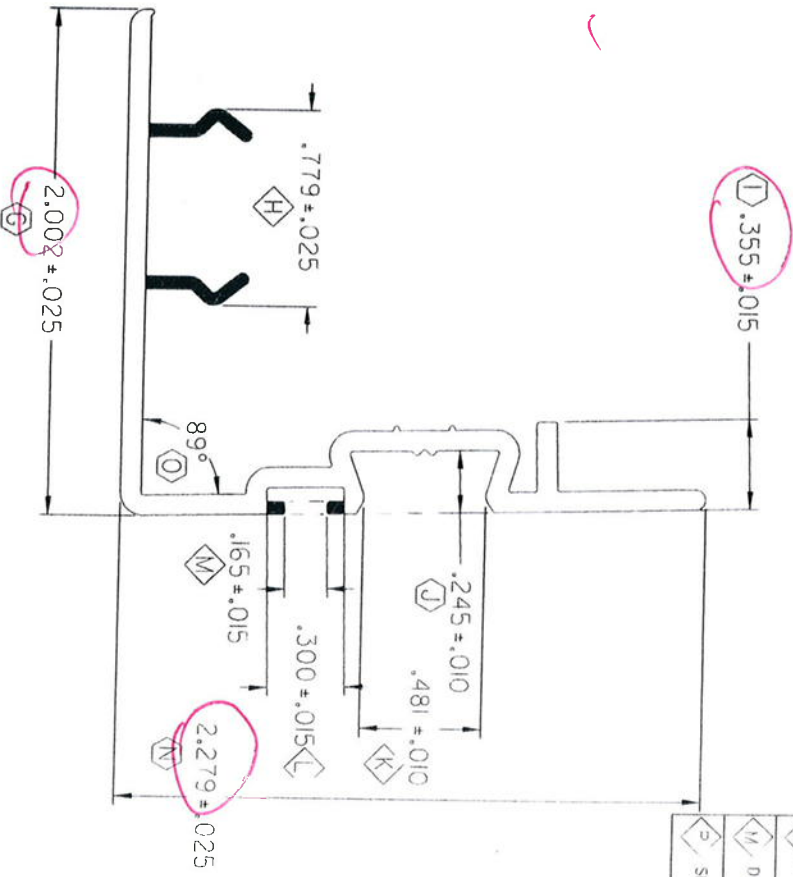
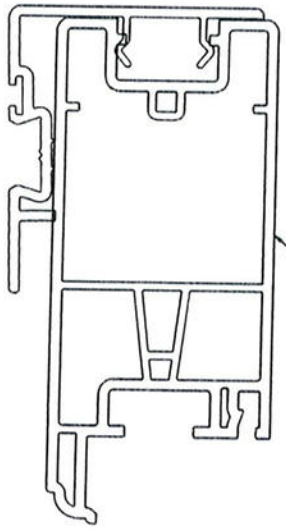
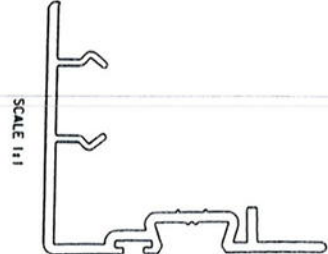

- NOTES:
- STANDARD STRAIGHTNESS CLASS A AND LENGTH TOLERANCES APPLY
 - INTERPRET ALL TOLERANCES AND FINISHES PER STD0010
 - UNSPECIFIED EXTERNAL RADIUS = .030
 - UNSPECIFIED EXTERNAL RADIUS = .030
 - UNSPECIFIED EXTERNAL WALL THICKNESS = .XXX ± .005
 - UNSPECIFIED EXTERNAL WALL THICKNESS = .XXX ± .005
 - UNSPECIFIED EXTERNAL WALL THICKNESS = .XXX ± .005

CONFIDENTIAL
 UNPUBLISHED WORK © 2010
 DECEUNINCK NORTH AMERICA

UNLESS OTHERWISE SPECIFIED DIMENSIONS SHALL BE IN INCHES TOL DIM ANGLES 2 PL ± .010 3 PL ± .005 INTERPRET DIM AND TOL PER ASME Y14.5M - 1994

DESIGN BY:	POV
DATE: 06/12/22	
DRAWN BY: JDM	
DATE: 07/01/02	
AUTH: [Signature]	DATE:
AUTH: [Signature]	DATE:
FILENAME:	
FILE NAME:	

deceuninck NORTH AMERICA

SASH ADAPTER

1000117 SH

SCALE: 2:1

SHEET: 1 OF 1

REVISION HISTORY

REV	DESCRIPTION	DATE	APPROVED
E	KPC	10/08/21	[Signature]

KEY PRODUCT CHARACTERISTICS

CHARACTERISTIC	VALUE
H DIMENSION	.754 ± .002
K DIMENSION	.471 ± .001
L DIMENSION	.285 ± .015
M DIMENSION	.150 ± .000
N	SNAP CONDITION

UNLESS OTHERWISE NOTED THE FOLLOWING TOLERANCES APPLY
 .001 - .010 .002 1.001 - 1.500 .010
 .011 - .500 .005 1.501 - 2.000 .015
 .501 - 1.500 .010 2.001 - 4.000 .020
 UNDESIGNED ANGLES 90° - 180° 0.003 PER SURFACE 900 .007

NOTES:
 1. WALL THICKNESS TO BE .065
 UNLESS OTHERWISE NOTED.

ELEMENT MATERIALS TECHNOLOGIES
 1924 Premier Row
 Orlando, FL 32809

ESP NO. ESP009140P-U
 Date Verified: 4/24/12
 Verified By: [Signature]

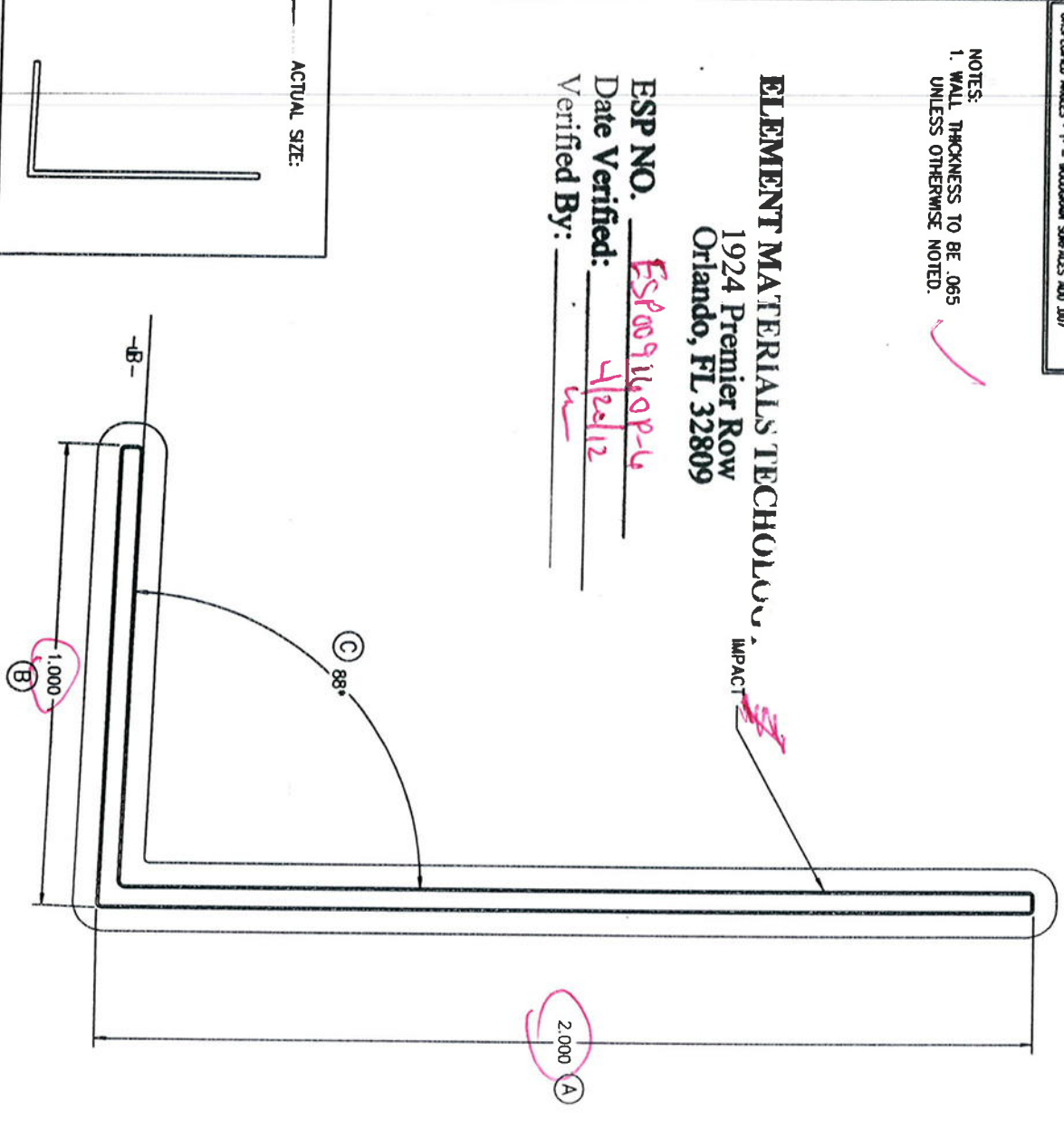

--- = EXPOSED SURFACE --- = WOODGRAIN SURFACE

REV	DATE	DESCRIPTION	BY
A	11/15/95	NEW TITLE BLOCK	CRB

QTS WITH:	5880
ROW CLASS:	B
IMPACT AREA:	NOTED

CONTROL DIMENSIONS									
DIM	METH	MIN	ENG	MAX	DIM	METH	MIN	ENG	MAX
A	C-0	1.970	2.000	2.030	X				
B	C-0	.970	1.000	1.030	Y				
C	OC	85*	88*	91*	Z				
D					AA				
E					BB				
F					CC				
G					DD				
H					EE				
I					FF				
J					GG				
K					HH				
L					II				
M					JJ				
N					KK				
O					LL				
P					MM				
Q					NW				
R					OO				
S					PP				
T					QQ				
U					RR				
V					SS				
W					TT				

Part Wt	Rigid:	Cap:	Flex:	Alum:	Total
(lbs/Ft)	.041	.019			.060

DAYTON TECHNOLOGIES
 AN ALCOA COMPANY
 DAYTON, OHIO
 Copyright 1995

NAME: _____
 DRAWN BY: MAB
 CHECKED BY: _____
 DATE: 8/25/87

SCALE: A : 1 "B"
 PART NO. 5870A
 PART DWG NO. P5870-A

ELEMENT MATERIALS TECHNOLOGY

1924 Premier Row
Orlando, FL 32809

FSP NO. ESP0091609-6
Date Verified: 4/26/12
Verified By: [Signature]

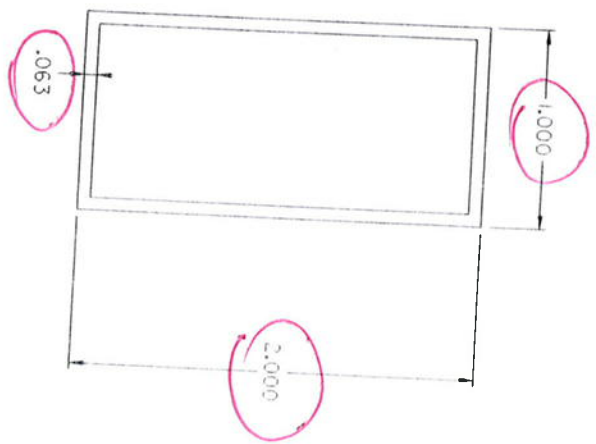

CONFIDENTIAL

UNPUBLISHED WORK © 2007
DECEUNINCK NORTH AMERICA

THIS DOCUMENT CONTAINS PROPRIETARY AND CONFIDENTIAL INFORMATION. DO NOT COPY OR DISCLOSE THIS INFORMATION WITHOUT THE EXPRESS WRITTEN CONSENT OF DECEUNINCK NORTH AMERICA. DECEUNINCK NORTH AMERICA RESERVES THE RIGHT TO CHANGE THIS DRAWING AND ANY ASSOCIATED DOCUMENTS.

UNLESS OTHERWISE SPECIFIED
DIM ARE IN INCHES
TOL ON ANGLES ± 1°
2 PL: ± 0.010° 3 PL: ± 0.005°
INTERPRET DIM AND TOL PER
ASME Y14.5M - 1994



THIRD ANGLE PROJECTION

DESIGN BY:

DATE:

DRAWN BY:

DATE:

AUTH:

DATE:

AUTH:

DATE:

FILENAME:

JGM

11/02/07

JGM

11/05/09

DATE:

DATE:

DATE:

113035

deceuninck®
NORTH AMERICA



351 NORTH GARVER ROAD
MONROE, OHIO 45080

NAME:

1" X 2" X 1/16" BOX TUFF

SIZE DWG. NO:

A

SCALE: 1:1 (LBS/FT.)

ALUMINUM

SHEET:

DATE:

ELEMENT MATERIALS TECHNOLOGY
1924 Premier Row
Orlando, FL 32809

ESP NO. ESP00916002-6
Date Verified: 4/20/12
Verified By: _____

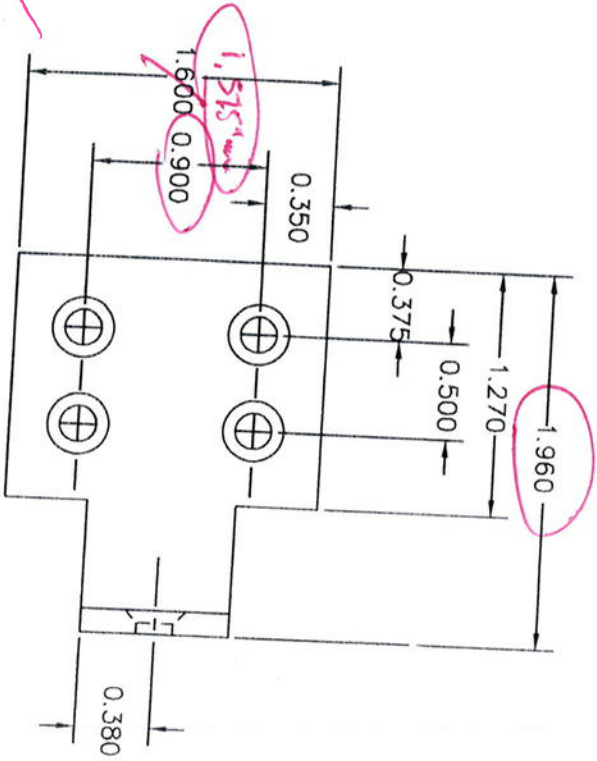
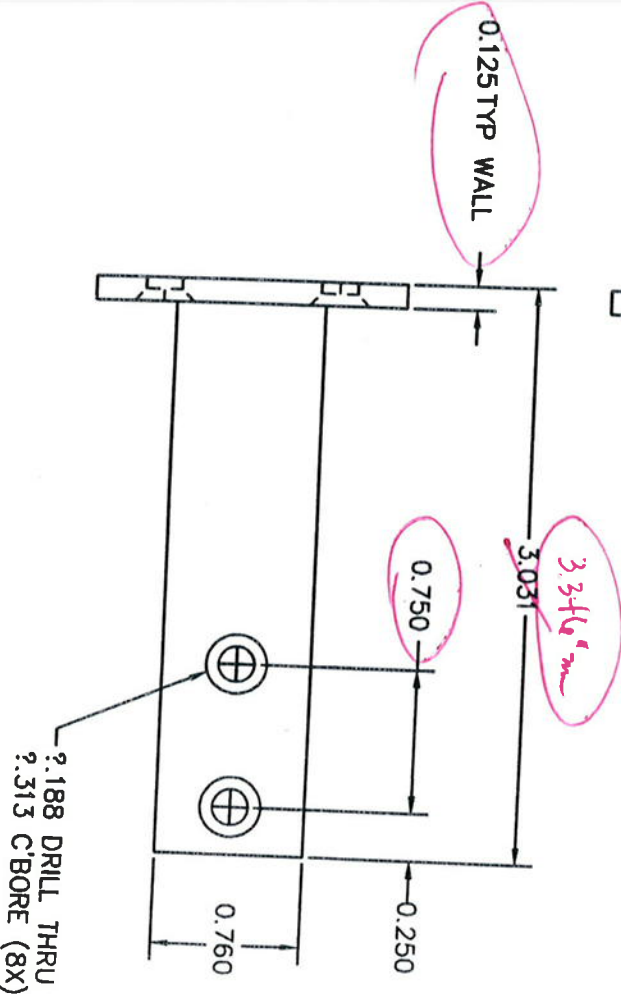
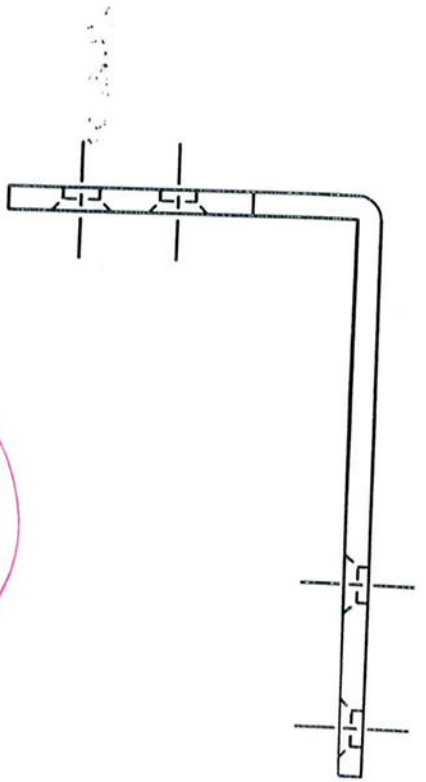

Vinyline®

VINYL BUILDING PRODUCTS INC.

AREA = _____
WEIGHT = _____

TOLERANCES (EXCEPT AS NOTED)
±0.010

DRAWN	MG	DATE	10/29/01	APPV'D		MAT'L	6063-T6	SCALE	1/1
-------	----	------	----------	--------	--	-------	---------	-------	-----

BRACKET

REV	BY	APPV'D	DATE	CHANGE

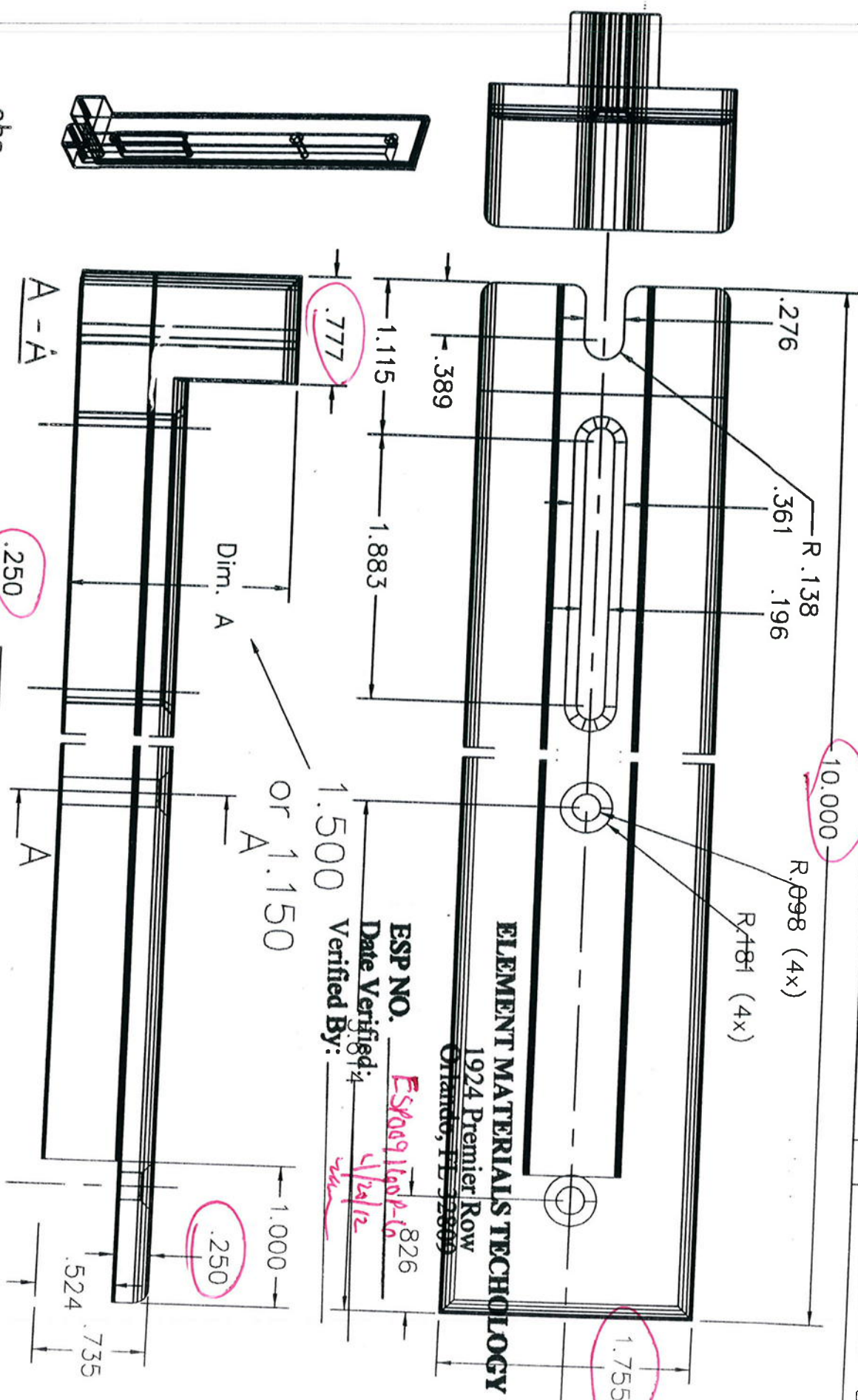

COLOR WHITE

REV	BY	APPV'D	DATE	CHANGE



VINYL BUILDING PRODUCTS INC.
 AREA = 8.109 cub in
 WEIGHT =
 TOLERANCES (EXCEPT AS NOTED)
 ± 0.010

DRAWN	MG	DATE	APPV'D	MAT'L	SCALE
		2/25/05		NYLON	1/1

BRACKET
 011h055-D

ESP NO. *ESp009140P-16* 826
 Date Verified: *4/24/12*
 Verified By: *[Signature]*

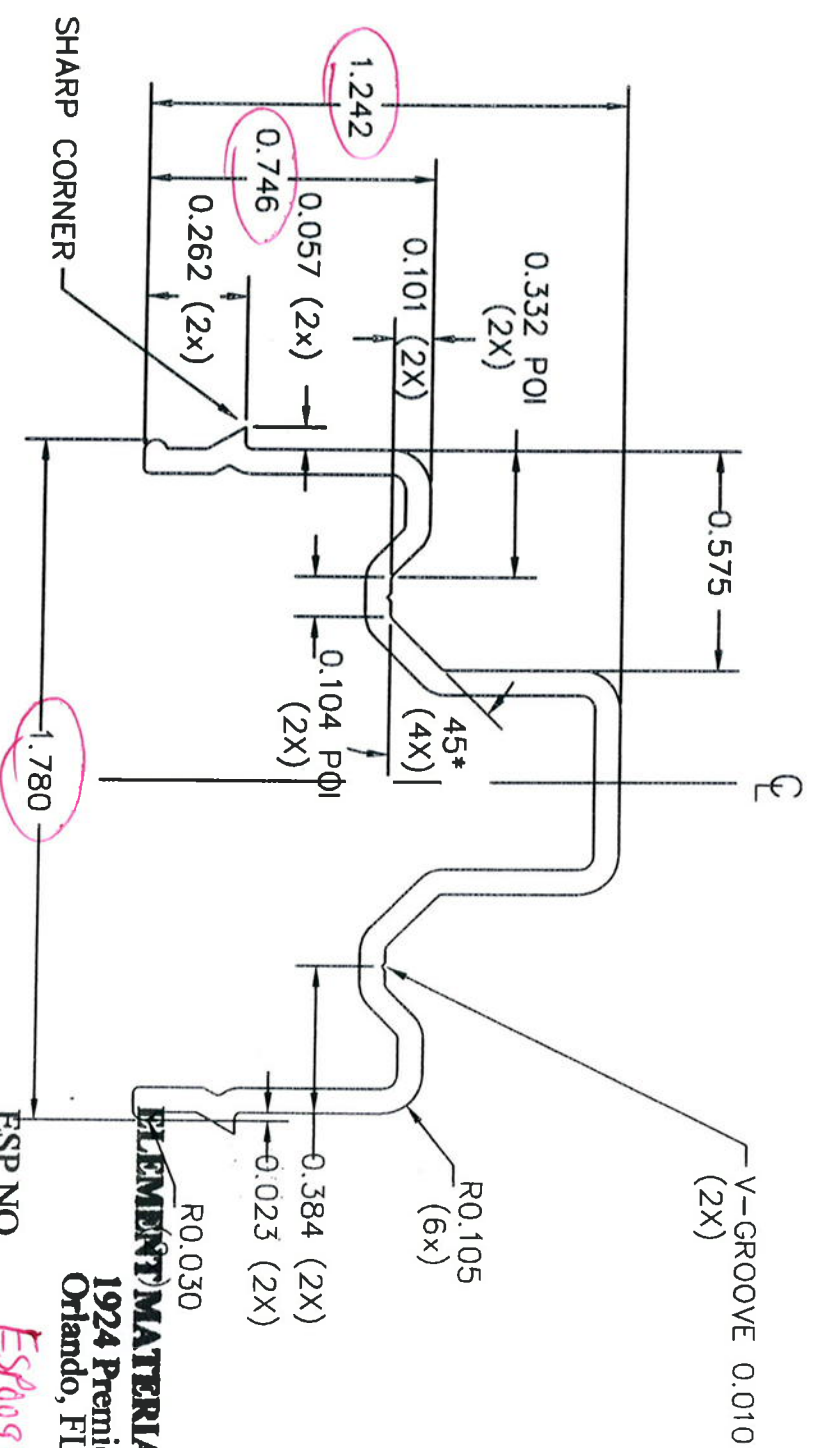

ACTUAL SIZE
NO EXPOSED SURFACES

- NOTES:
1. ALL UNSPECIFIED RADII 0.015.
 2. ALCOA P/N 23111 (WHITE P-001, DESERT SAND P-029)

ELEMENT MATERIALS TECHNOLOGY
 1924 Premier Row
 Orlando, FL 32809

ESP NO. ESP009140 P16
 Date Verified: 4/25/12
 Verified By: [Signature]

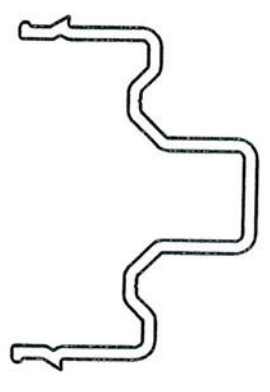

Vinylines® VINYL BUILDING PRODUCTS INC.

AREA = 0.269 sq in
 WEIGHT = 0.316 lb/ft

TOLERANCES (EXCEPT AS NOTED)
 ±0.010

DRAWN	MG	DATE	10/28/3	APPV'D	
SNUBBER					
MAT'L	8061-16,6105	SCALE	2/1		
					10300148

REV	BY	APPV'D	DATE	CHANGE

NO EXPOSED SURFACES

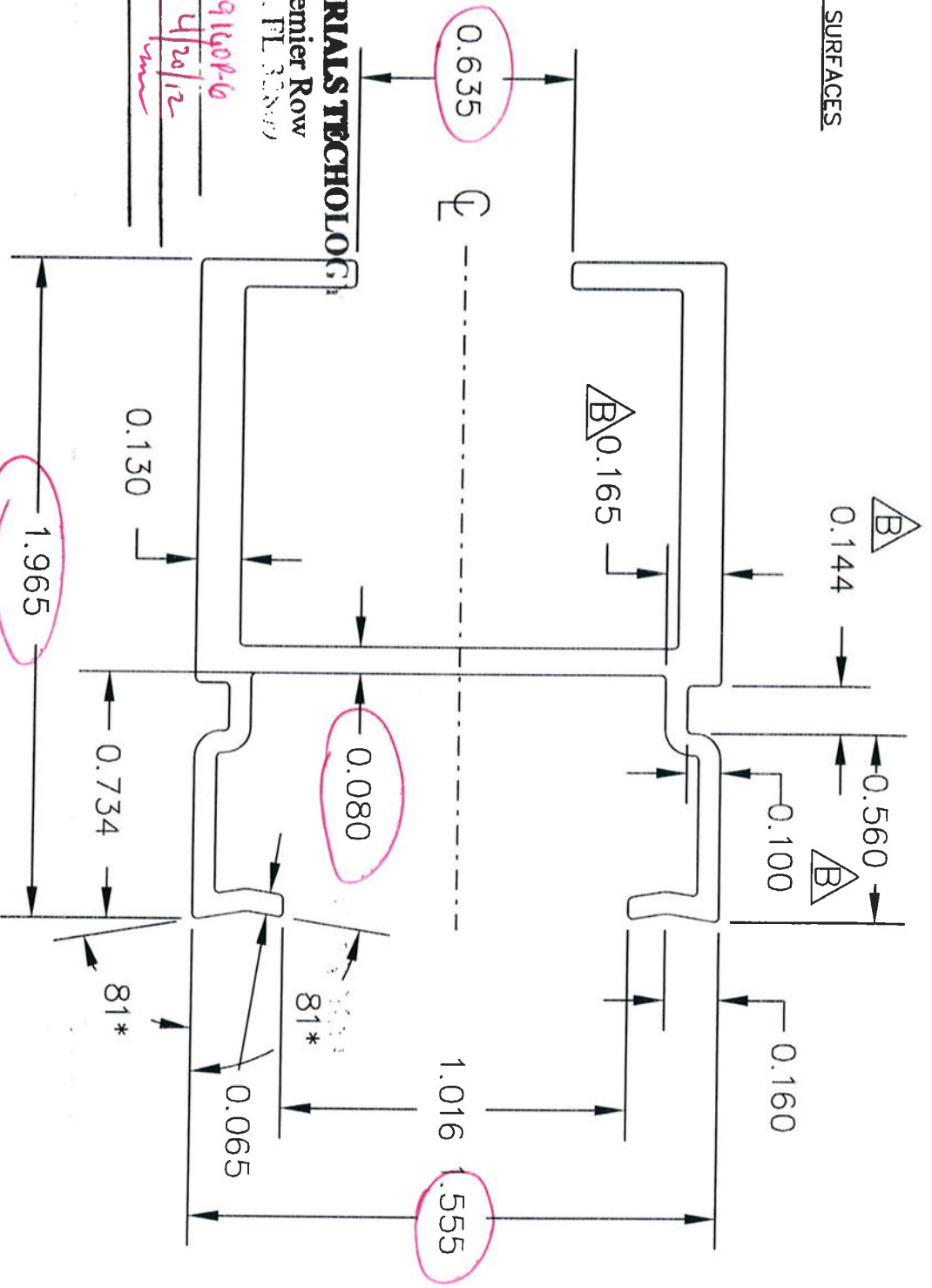

ELEMENT MATERIALS TECHNOLOGY

1924 Premier Row
Orlando, FL 32830

ESP NO. ESP009160R-6
 Date Verified: 4/20/12
 Verified By: [Signature]

- NOTES:
 1. ALL UNSPECIFIED RADII ARE 0.015.
 2. MAKE FROM EITHER 6061-T6 or 6105-T6 ALUMINUM.
 3. ALCOA PART NUMBER 23441.

DNA# 10300150

B	CC	10/28/04	Renamed drawing 011H035B Dimension change
A	AL	6/4/04	CHANGED MATERIAL SPECS TO MAKE FROM EITHER 6061-T6 or 6105-T6 ALUMINUM
REV	BY	APPVD	DATE
			CHANGE



VINYL BUILDING PRODUCTS INC.

AREA = .612 sq in.
 TOTAL WEIGHT = .7175 lb/ft.

TOLERANCE
 ±0.010

DRAWN	CTC	DATE	10/28/04	APPVD	MATL	Al 6105 T-6	SCALE	2:1
Sash Reinforcement								10300150

NO EXPOSED SURFACES

ELEMENT MATERIALS TECHNOLOGY
 1924 Premier Row
 Orlando, FL 32809

ESP NO. ESP009100P0
 Date Verified: 4/20/12
 Verified By: _____

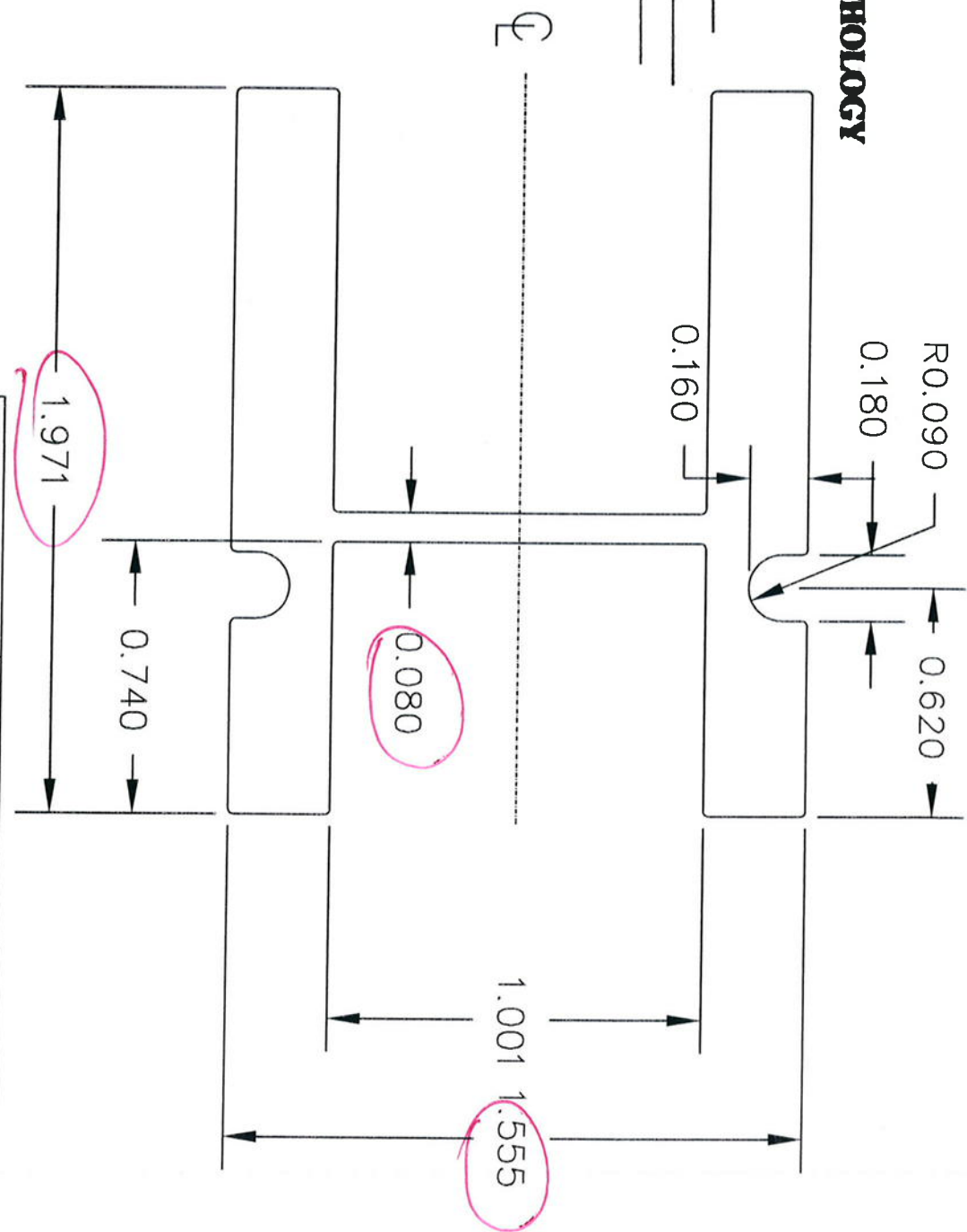

NOTES:
 1. ALL UNSPECIFIED RADII ARE 0.015.



VINYL BUILDING PRODUCTS INC.

AREA = 1.121
 WEIGHT = 1.316 lb/ft
 TOLERANCES (EXCEPT AS NOTED)
 ? .010 [0.25]

DRAWN	MG	DATE	02/05/03	APPVD		MAT'L	6T05-15 6061-T6	SCALE	2/1
SASH REINFORCEMENT XHD A 10300151									

REV	BY	APPVD	DATE	CHANGE

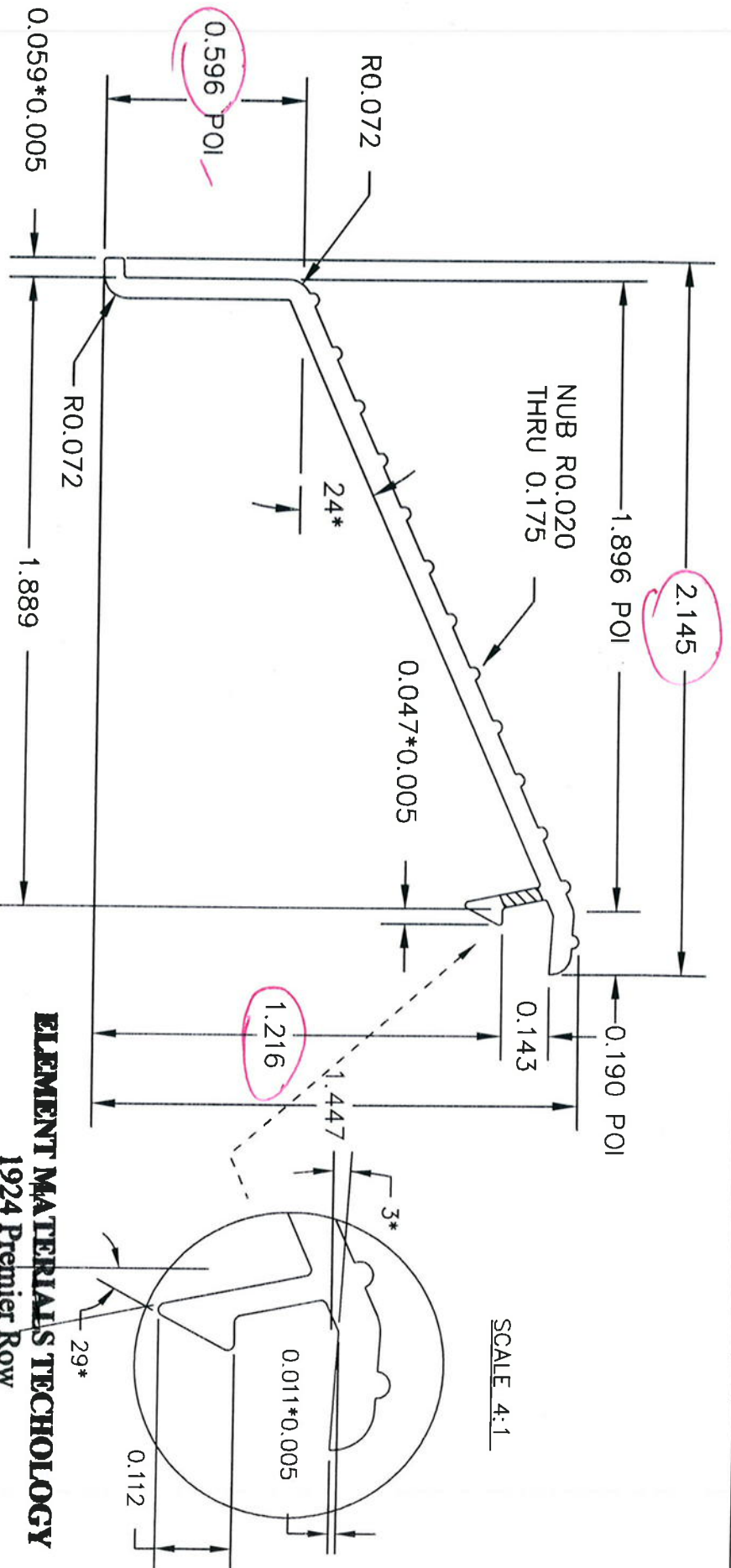

SCALE 4:1

- NOTES:
1. ALL UNSPECIFIED RADII ARE 0.010.
 2. WALL THICKNESS.
 3. PAINT WITH ALCOA, PPG COLOR UC73603, POLYCRON WHITE.



EXPOSED SURFACE
ACTUAL SIZE

ESP NO. F-88009100-A-6
Date Verified: 4/20/12
Verified By: W

ELEMENT MATERIALS TECHNOLOGY
1924 Premier Row
Orlando, FL 32809

A	MB	2/13/03	ADDED NOTE 3.
REV	BY	APPV'D	DATE
			CHANGE

Vinyline®

VINYL BUILDING PRODUCTS INC.

AREA = 0.195
WEIGHT = 0.229 lb/ft

TOLERANCES (EXCEPT AS NOTED)
?.010 [0.25]

DRAWN	MG	DATE	12/26/00	APPV'D	MAT'L	5061-16	SCALE	2/1
SILL COVER. SLIDER				A	10300171			

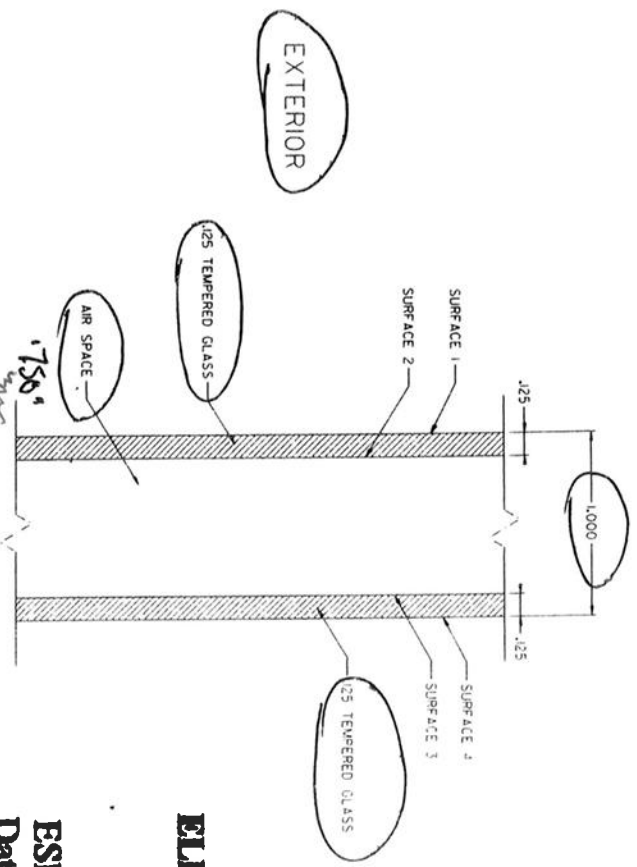

ELEMENT MATERIALS TECHNOLOGY

1924 Premier Row
Orlando, FL 32809

ESP NO. ESP009160 P-S & P-6
Date Verified: 4/26/12
Verified By: [Signature]

ELEMENT MATERIALS TECHNOLOGY

1924 Premier Row
Orlando, FL 32809

ESP NO. ESP009160 P-6
Date Verified: 4/26/12
Verified By: [Signature]

1" OVERALL HEIGHT
1/8" TEMPERED PANES

CONFIDENTIAL

UNPUBLISHED WORK © 2008
DECUNINCK NORTH AMERICA

THIS DOCUMENT CONTAINS PROPRIETARY AND CONFIDENTIAL INFORMATION. DO NOT COPY OR REPRODUCE IN ANY MANNER WITHOUT THE EXPRESS WRITTEN CONSENT OF DECUNINCK NORTH AMERICA. ANY UNAUTHORIZED USE OR DISSEMINATION OF THIS INFORMATION SHALL BE CONSIDERED A VIOLATION OF THE PATENT RIGHTS AND ASSOCIATED DOCUMENTS.

DESIGN BY	DATE	DATE	DATE
DESIGNED BY	DATE	DATE	DATE
DATE	DATE	DATE	DATE
DATE	DATE	DATE	DATE

decuninck
NORTH AMERICA